

1. In a horizontal position, insert the injection pen with pen needle attached into the Penfine Remover (in the blue opening).



2. Hold the pen at the height of the cartridge and turn the pen at least three times in the direction indicated or until the pen needle is screwed off the injection pen. Hold the Penfine Remover steady in your hand.



3. Hold the Penfine Remover close to the opening of the disposal box and eject the pen needle by pressing the red button. The diameter of the disposal box opening must be at least 4 cm.

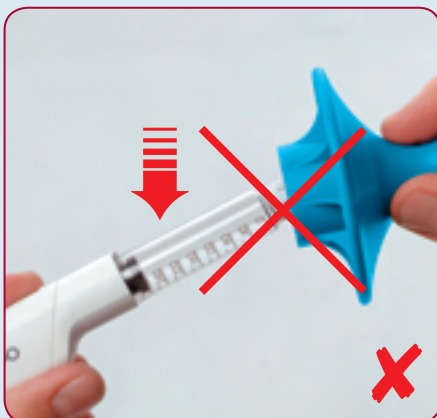

1. The Penfine Remover and injection pen must never be at an angle (no bending)!



2. Never press the red button when inserting the injection pen with pen needle attached into the Penfine Remover!

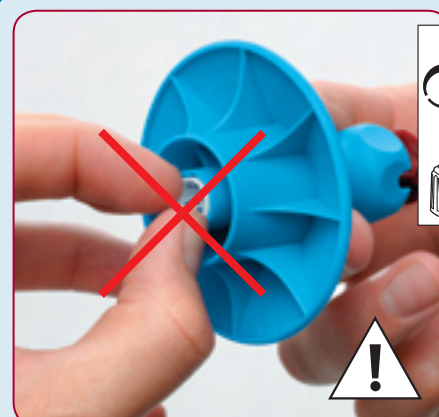

3. Fingers must never come into contact with the pen needle. → Risk of infection!



4. Pen needles must never be disposed of in household rubbish. → Risk of infection! Use the proper disposal boxes.



1. Thread the cord through the opening provided in the red button.
2. Hang the Remover up by the cord in a suitable location.
3. Penfine remover provided with patient's name.



Penfine Removers may only be handed to the patient unused and in their original packaging!
→ 1 patient = 1 Remover ←